



INSTRUCTION BULLETIN

No. 340515
Machine: ATLV™ 4300
Published: 4-02
Rev. 00

NOTE: DO NOT DISCARD the Parts List from the Instruction Bulletin. Place the Parts List in the appropriate place in your machine manual for future reference. Retaining the Parts List will make it easier to reorder individual parts and will save you the cost of ordering an entire kit.

NOTE: Numbers in parenthesis () are reference numbers for parts listed in Bill of Materials.

Installation instructions for **kit number 368660**

DESCRIPTION:

This kit contains the parts needed to install a broom holder on the model ATLV™ 4300 Litter Vacuum.

Please follow step-by-step instructions.

SPECIAL TOOLS / CONSIDERATIONS: NONE

(Estimated time to complete: 1 hour)

PREPARATION:

(Refer to FIG. 1)

1. Stop the machine on a clean, level working surface and set the parking brake. Turn off the machine and remove the key.

FOR SAFETY: Before leaving or servicing machine, stop on level surface and set parking brake. Then turn off machine and remove key.

INSTALLATION:

(Refer to FIG. 1)

1. Position the new broom holder bracket (1) in place on the right rear fender of the machine.
2. Using the broom holder bracket (1) as a template, mark and drill two 9 mm (11/32) diameter holes in the fender.
3. Secure the new broom holder bracket (1) to the fender with two hex screws (2), flat washers (3) and two hex nuts (4).

TENNANT COMPANY
P. O. Box 1452
Minneapolis, MN 55440-1452

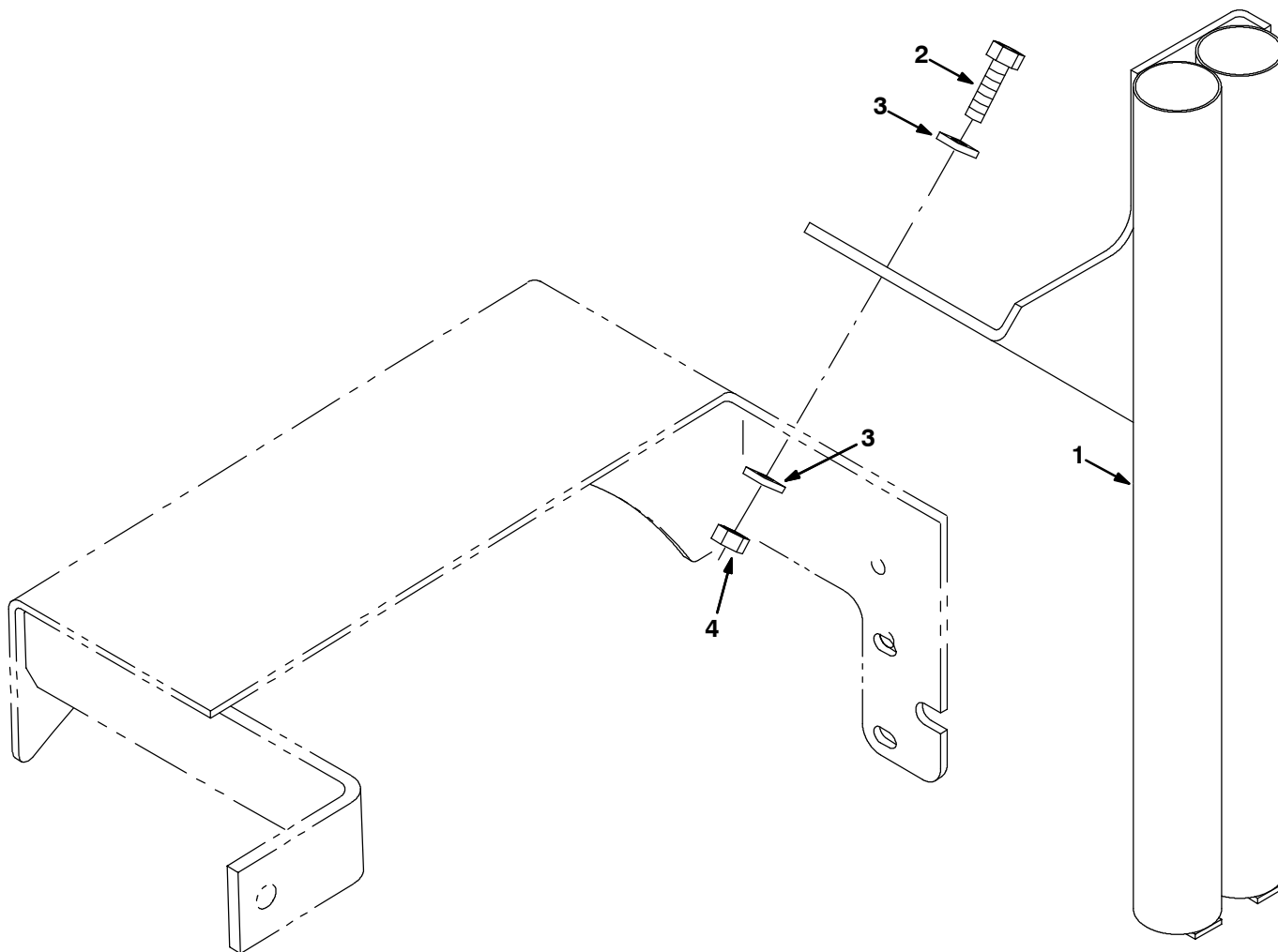

FIG. 1 - BROOM HOLDER INSTALLATION

BILL OF MATERIALS FOR BROOM HOLDER KIT 368661

Ref.	TENNANT Part No.	Description	Qty.
1	368653	Bracket wldt, mtg, broom holder	1
2	09740	Screw, hex, M08 X 1.25 X 20, Ss	2
3	01685	Washer, flat, 0.31 Ss	4
4	07791	Nut, hex, flng, M08 X 1.25	2

TENNANT COMPANY
P. O. Box 1452
Minneapolis, MN 55440-1452